

TRELIÇA METÁLICA

QUADRO DE FERROS

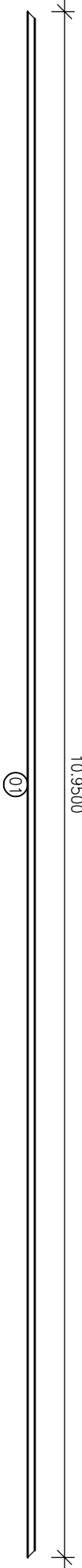
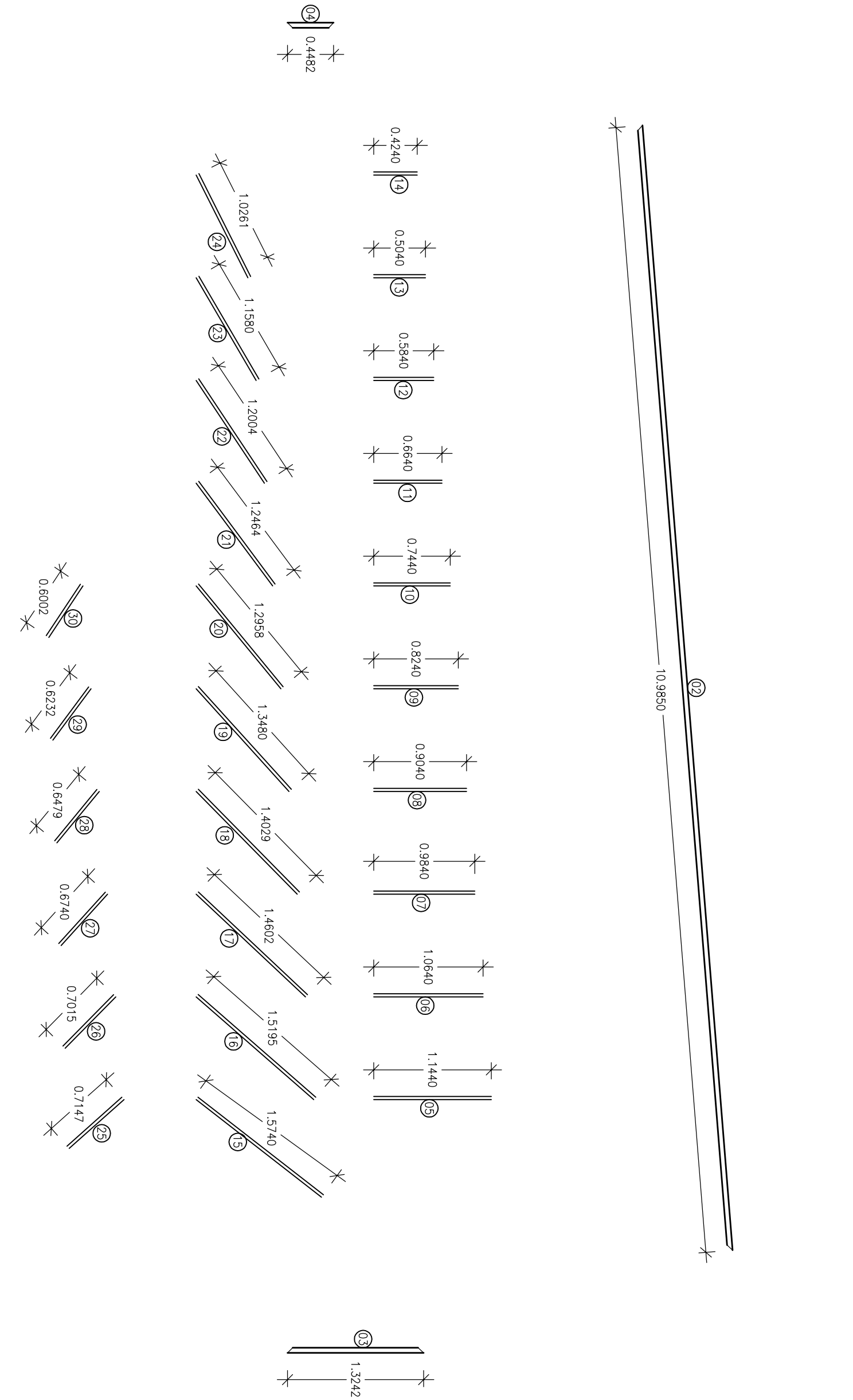

MOLDAGEM DOS PERFIS

POS	TIPO	PERFIL	COMPR	Kg/m	PESO
01	BANZO INFERIOR	U 75 x 40 x 1/8"	10,95	3,72	81,47
02	BANZO SUPERIOR	U 75 x 40 x 1/8"	10,99	3,72	81,47
03	MONTANTE	U 75 x 40 x 1/8"	1,32	3,72	9,82
04	MONTANTE	U 75 x 40 x 1/8"	0,45	3,72	3,35
05	MONTANTE	2X L 25 x 20 x 1/8"	1,14	1,08	4,92
06	MONTANTE	2X L 25 x 20 x 1/8"	1,06	1,08	4,58
07	MONTANTE	2X L 25 x 20 x 1/8"	0,98	1,08	4,23
08	MONTANTE	2X L 25 x 20 x 1/8"	0,90	1,08	3,89
09	MONTANTE	2X L 25 x 20 x 1/8"	0,82	1,08	3,54
10	MONTANTE	2X L 25 x 20 x 1/8"	0,74	1,08	3,20
11	MONTANTE	2X L 25 x 20 x 1/8"	0,66	1,08	2,85
12	MONTANTE	2X L 25 x 20 x 1/8"	0,58	1,08	2,51
13	MONTANTE	2X L 25 x 20 x 1/8"	0,50	1,08	2,16
14	MONTANTE	2X L 25 x 20 x 1/8"	0,42	1,08	1,81
15	MONTANTE	2X L 25 x 20 x 1/8"	1,57	1,08	6,78
16	MONTANTE	2X L 25 x 20 x 1/8"	1,52	1,08	5,57
17	MONTANTE	2X L 25 x 20 x 1/8"	1,46	1,08	6,31
18	MONTANTE	2X L 25 x 20 x 1/8"	1,40	1,08	6,05
19	MONTANTE	2X L 25 x 20 x 1/8"	1,35	1,08	5,83
20	MONTANTE	2X L 25 x 20 x 1/8"	1,30	1,08	5,62
21	MONTANTE	2X L 25 x 20 x 1/8"	1,24	1,08	5,36
22	MONTANTE	2X L 25 x 20 x 1/8"	1,20	1,08	5,18
23	MONTANTE	2X L 25 x 20 x 1/8"	1,16	1,08	5,01
24	MONTANTE	2X L 25 x 20 x 1/8"	1,02	1,08	4,41
25	MONTANTE	2X L 25 x 20 x 1/8"	0,71	1,08	3,07
26	MONTANTE	2X L 25 x 20 x 1/8"	0,70	1,08	3,02
27	MONTANTE	2X L 25 x 20 x 1/8"	0,67	1,08	2,89
28	MONTANTE	2X L 25 x 20 x 1/8"	0,64	1,08	2,76
29	MONTANTE	2X L 25 x 20 x 1/8"	0,62	1,08	2,68
30	MONTANTE	2X L 25 x 20 x 1/8"	0,60	1,08	2,59

PESO PARA 1 TRELIÇA

284,23

PESO TOTAL

6070,44

